

FFT *weldtec* **Mobile TipChanger**

*„The **FFT**weldtec **Mobile TipChanger** enables time-optimized and automatic changing of electrode caps on stationary welding guns.“*

one step ahead in **INTELLIGENT** production systems

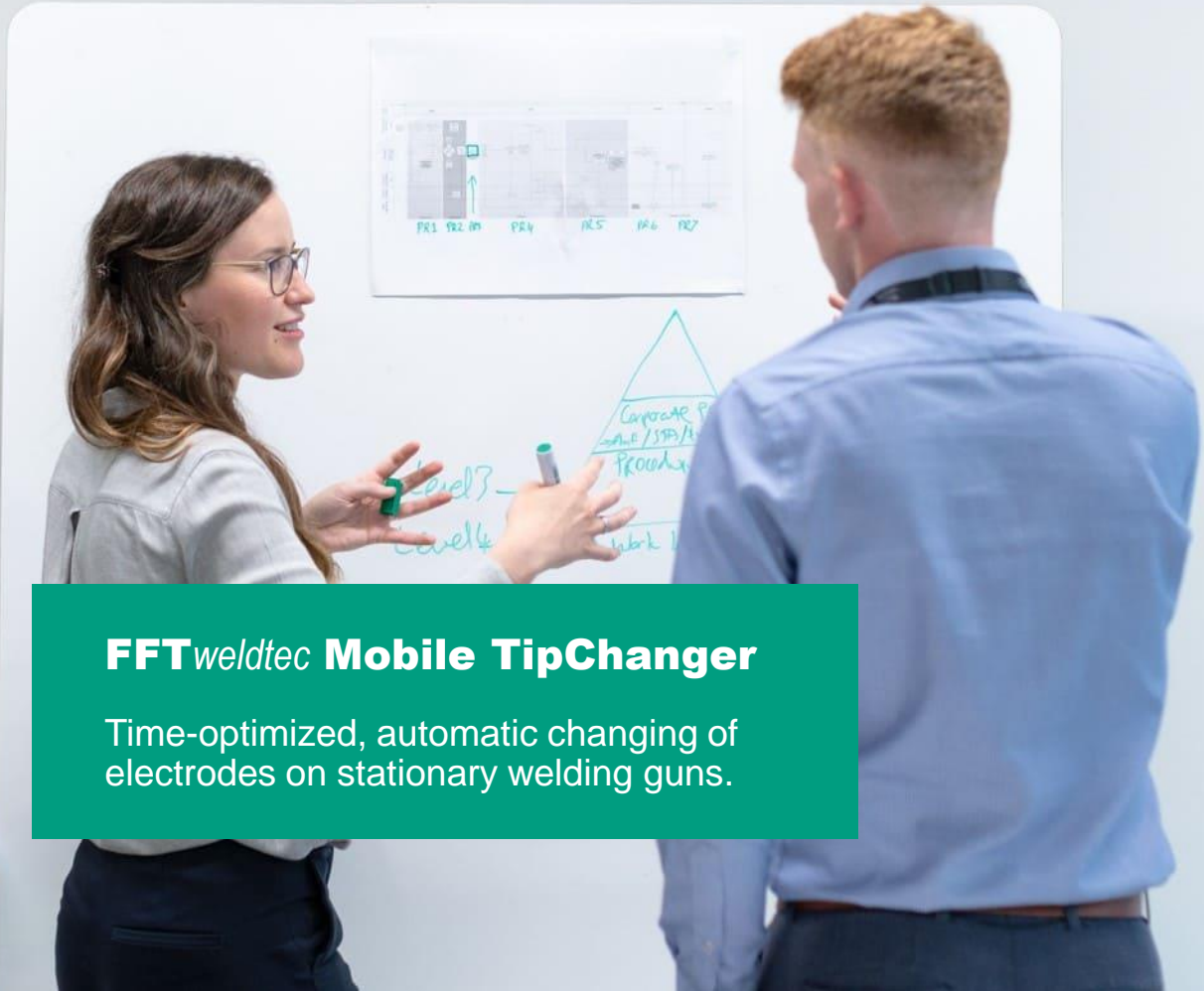

FFT*weldtec* **Mobile TipChanger**

Time-optimized, automatic changing of electrodes on stationary welding guns.

1

Description

Functionality / system advantages of the **FFT***weldtec* **Mobile TipChanger**

2

Technical information

Technical data / components of the **FFT***weldtec* **Mobile TipChanger**

3

Advantages

Advantages and benefits of the **FFT***weldtec* **Mobile TipChanger**

4

Options

Collection bin, docking station and high force technology

Description of the **Mobile TipChanger**

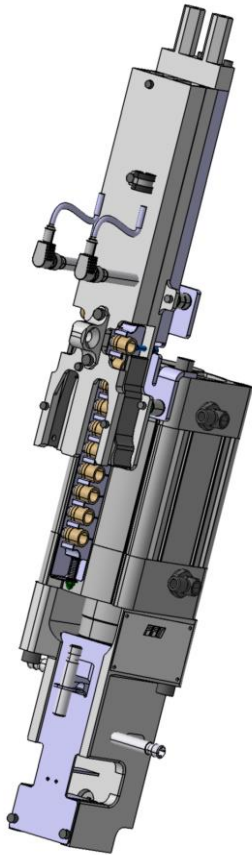

Time-optimized, smooth and automatic changing of electrode caps on stationary welding guns.



Combination of compact design and low weight for mounting on the robot gripper.



The electrode caps are changed one after the other by aligning the **FFTweldtec Mobile TipChanger** to the stationary welding gun.

Description of the **Mobile TipChanger**

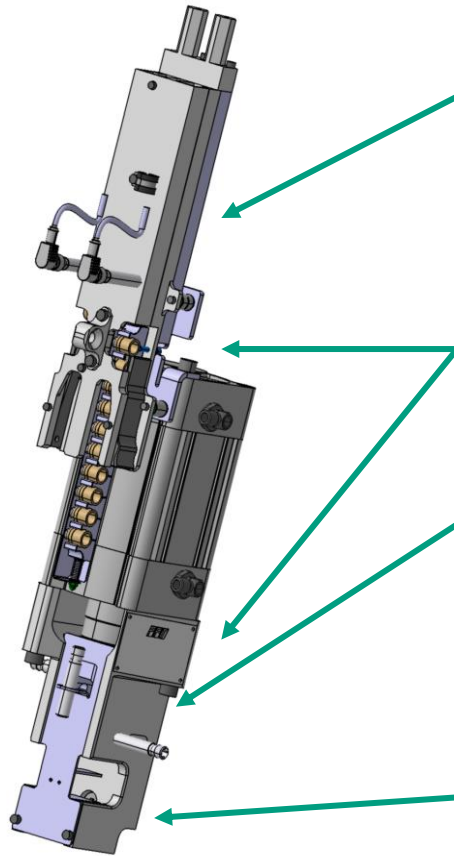

The cap strips of the magazine unit can be preloaded outside the system. The fill level in the cap magazine and cap present / removed is queried via sensors.

The cap magazine is mounted in the same orientation as the changeover tool, no reorientation of the **FFTweldtec Mobile TipChanger** necessary.

Loosening of the electrode cap via wedge-shaped separating slide which moves linearly between the electrode cap and the starting collar of the electrode shaft, sensing of the position of the wedge-shaped separating slide via sensors.

The loosened electrode caps automatically fall into a catch basket.

Components of the Mobile TipChanger

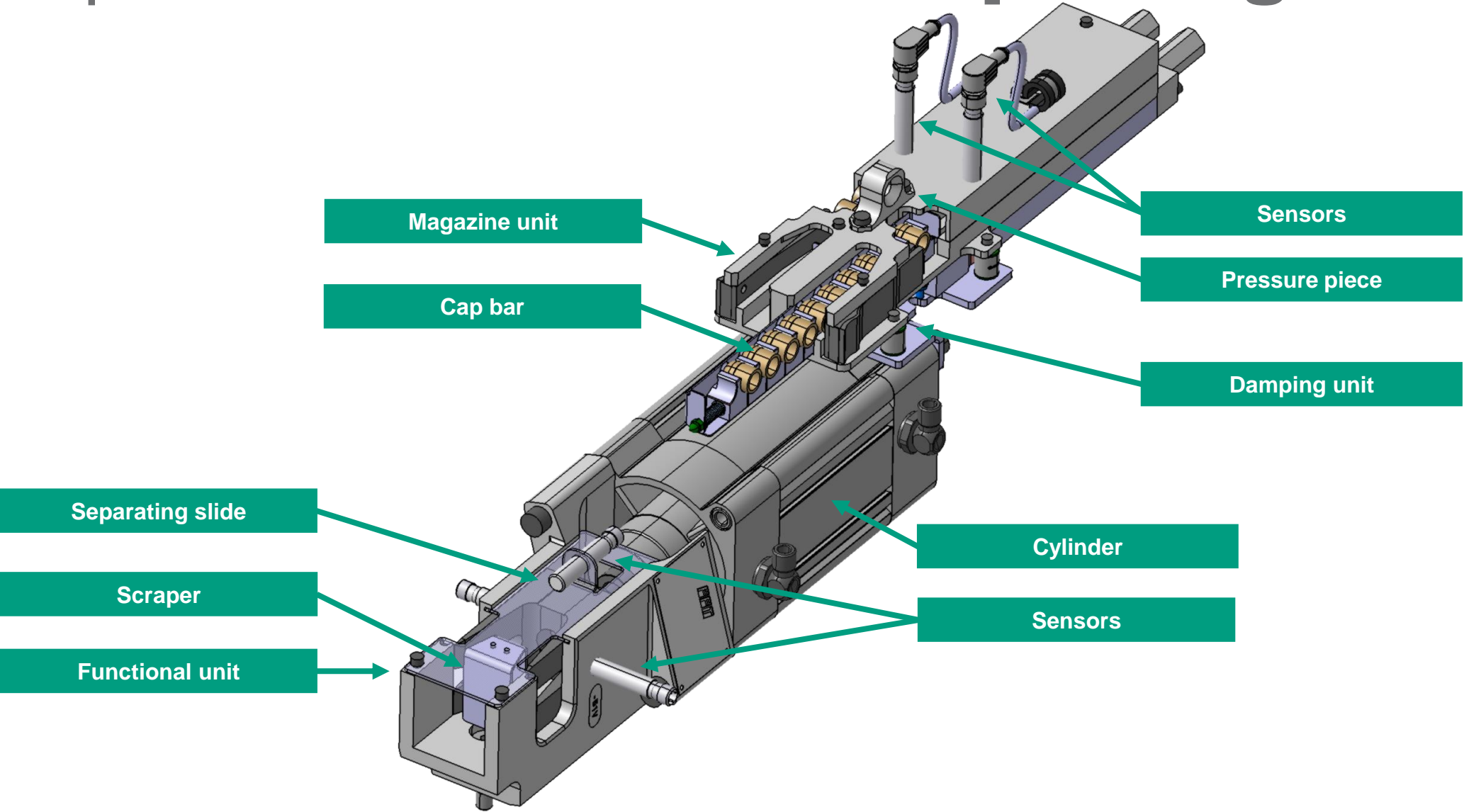

Functionality

Function and magazine unit

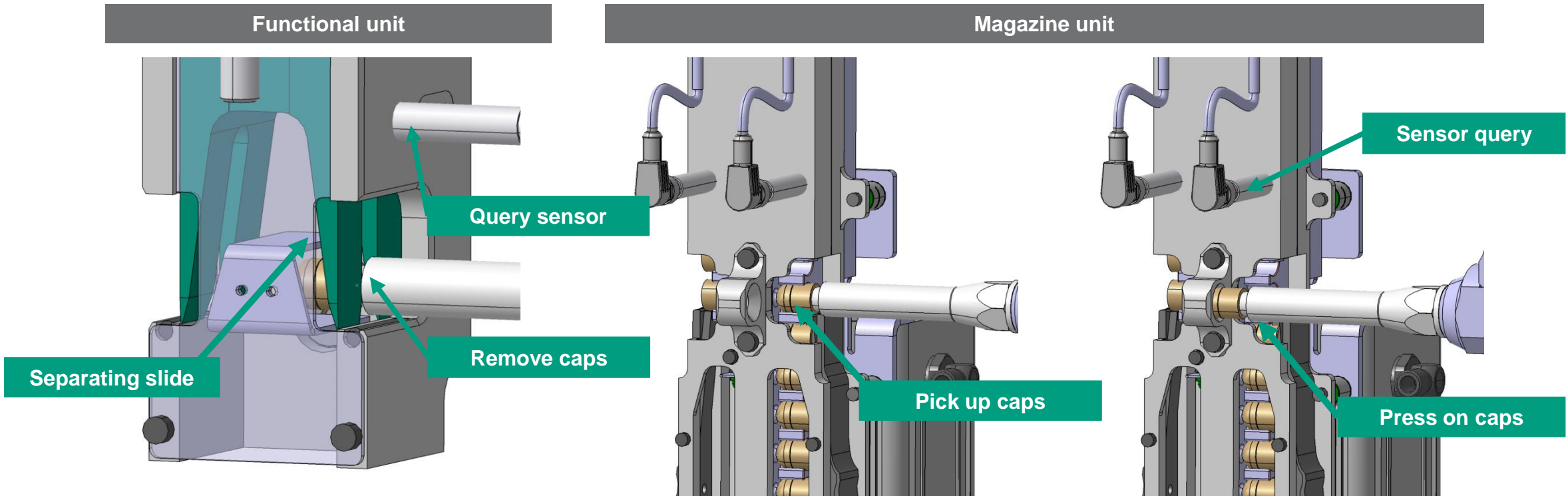

2

Technical information

Technical data / components of the
FFT_{weldtec} Mobile TipChanger

one step ahead in **INTELLIGENT** production systems

Technical information

Technical data of the **FFT***weldtec* **Mobile TipChanger**

| | |
|-----------------------------------|--|
| Height | 285 mm |
| Wide | 185 mm |
| Length | 705 mm |
| Weight | 10,5 Kg |
| Compressed air | 5,5-6,0 bar |
| Rated voltage | 24 V |
| Filling quantity caps in magazine | 10 Piece per page |
| Time change cycle per clamp | ca. 20 sec |
| Distance cap and shaft | min 3 mm, max 6 mm |
| Minimum electrode gap | 45 mm |
| Electrode caps | Standard F13x18/F16x20/F16x22 more on request |

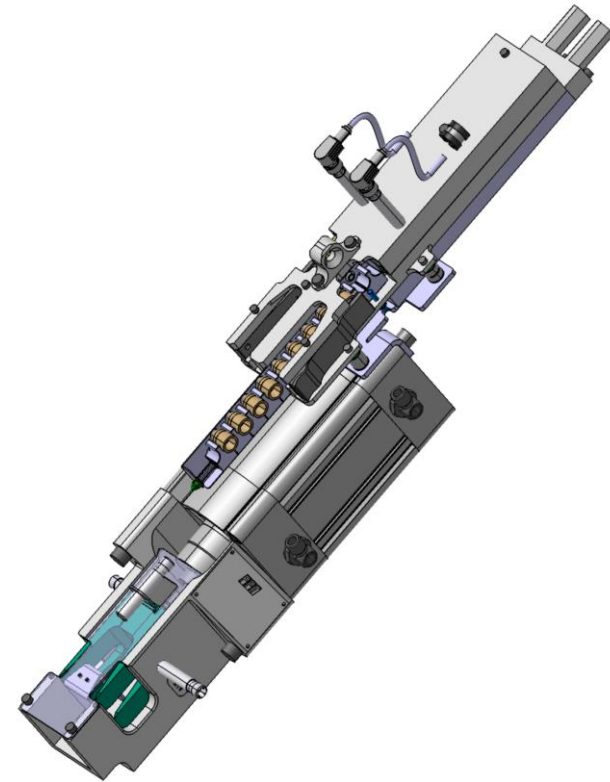



We support our customers in efficiently implementing their production systems according to their specifications.

“

DO YOU NEED AN
INDIVIDUAL SOLUTION
FOR YOUR TASK?

3

Advantages

Advantages and benefits of the **FFT***weldtec* **Mobile TipChanger**

one step ahead in **INTELLIGENT** production systems

Advantages of the **Mobile TipChanger**



Cost savings and increased efficiency

- Reduced wear of the electric shafts
- Increased availability and productivity due to time-optimized changeover



Optimized cap changing process

- Different shanks and caps possible
- Minimal space requirement on the gripper
- Simple programming
- Filling of the magazine via quick-change cap strips

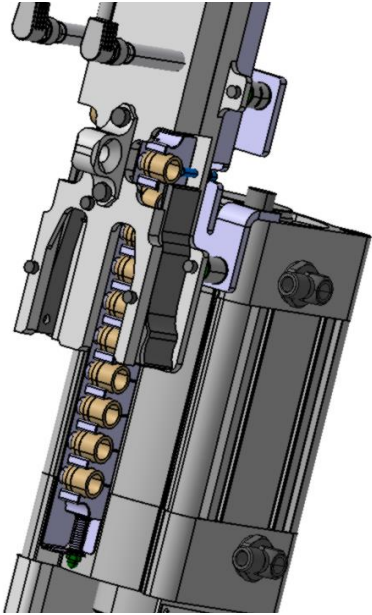

SERVICE OPTIONS

We support your project from the idea to the realization and gladly beyond.



We take into account quality and deadline requirements and we assume the responsibility for the project until turnkey handover.



Consulting

Use our experience for your tasks



Project Management

Support from the idea to the start of production



Risk Analysis

Identification of risks in the process



Custom design

Creation of individual solutions



Manufacturing

Successful manufacturing with modern technologies



Documentation

Clear and logical



Conformity

Compliance with standards and regulations



After Sales

Competent service through FFT

4

Options

Collection bin, high power technology
and docking station

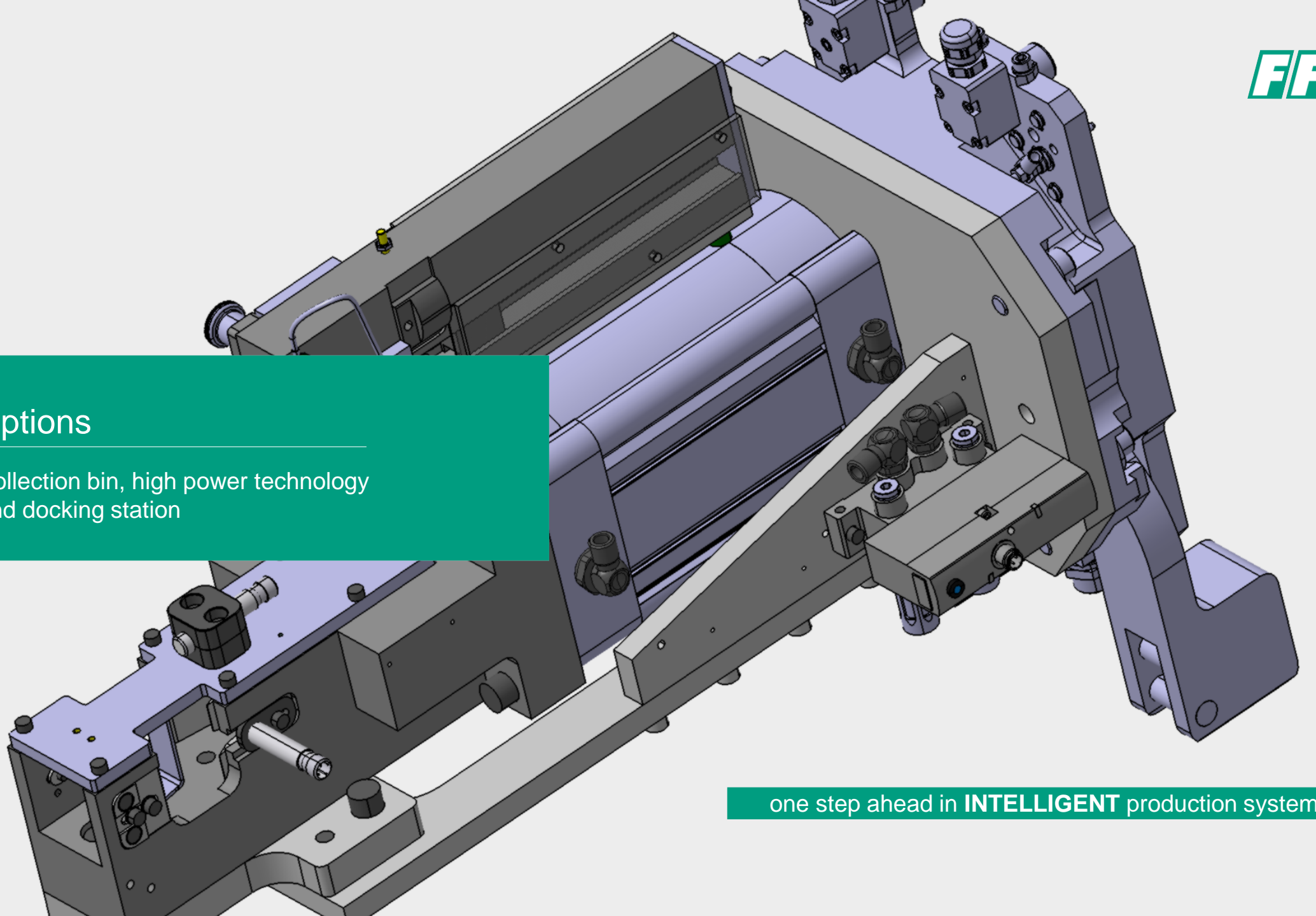

one step ahead in **INTELLIGENT** production systems

The standardized collection container

The standardized collection container **FFT**weldtec **Mobile TipChanger**

- The FFT collection container is used for the targeted disposal of used electrode caps in production plants in the automotive industry.
- The electrode caps are emptied from the collecting container via the disposal flap (manually operated).
- The caps are directed into a transport container via the chute.

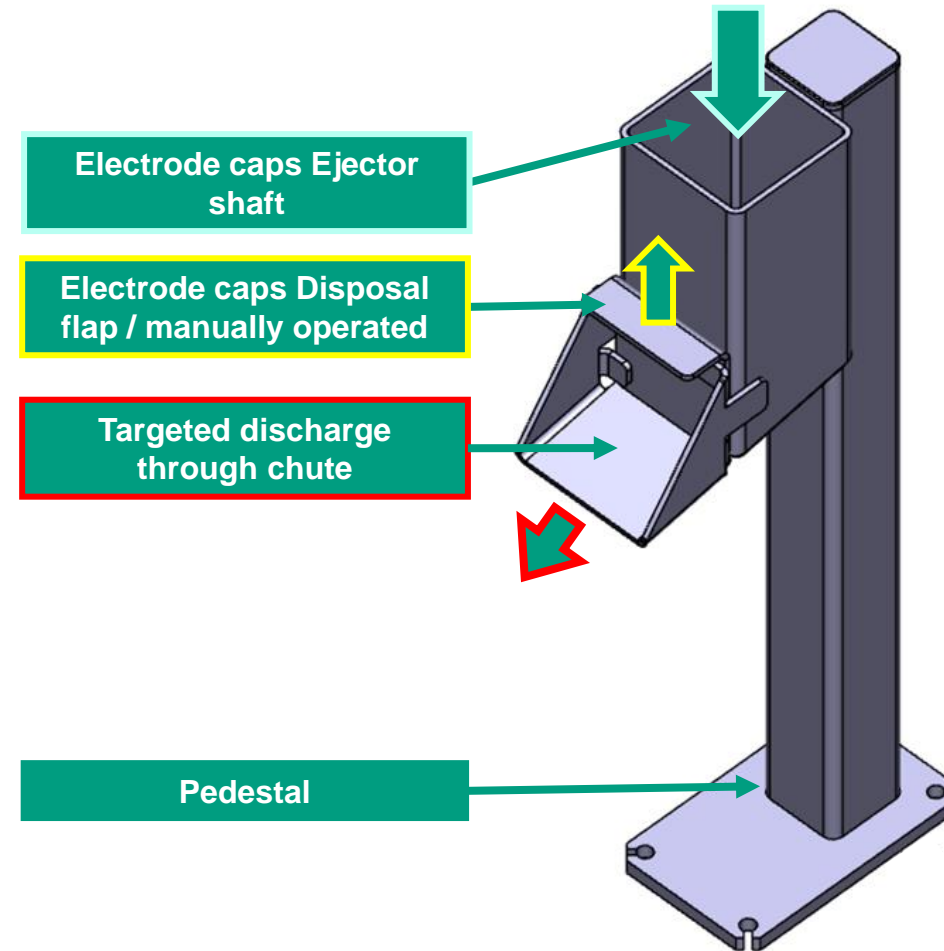

Technical information

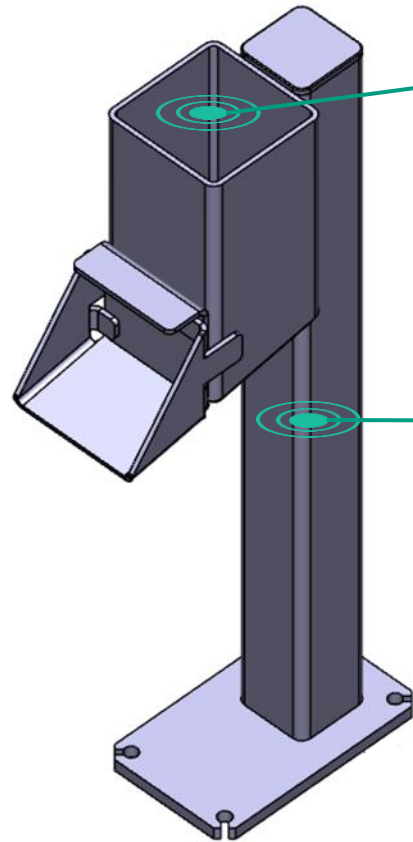

Technical data

| | |
|-------------|--------|
| Height | 615mm |
| Wide | 110 mm |
| Depth | 270 mm |
| Dead weight | 8,5kg |

Advantages

- Targeted disposal of used electrode caps
- Minimum space requirement
- No programming necessary
- Standardized design and easy handling

High force version

For electrode caps of resistance spot welding

The **FFT**weldtec **Mobile TipChanger** enables smooth and automatic changing of used **electrode caps of resistance spot welding** on stationary guns.

The **FFT**weldtec **Mobile TipChanger** releases the electrode caps by means of a wedge-shaped separating slide which moves in linearly between the electrode cap and the starting collar of the electrode shaft.

The electrodes are pressed against the welding gun for resistance spot welding using high-force technology.

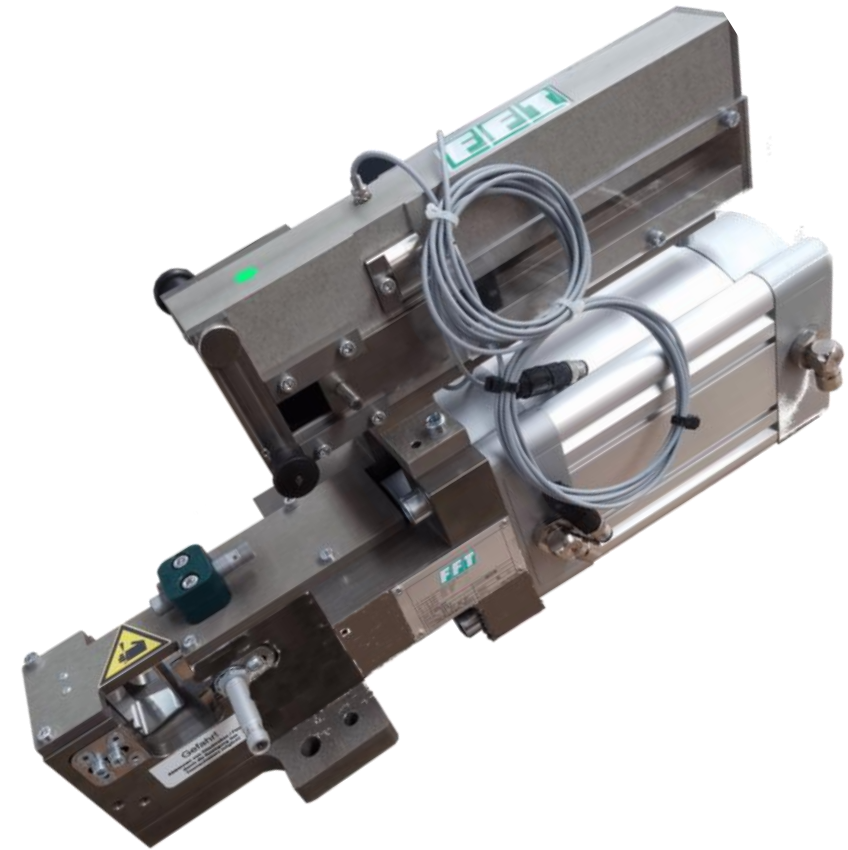

Structure of the high force version

Structure of the **FFT**weldtec **Mobile TipChanger**

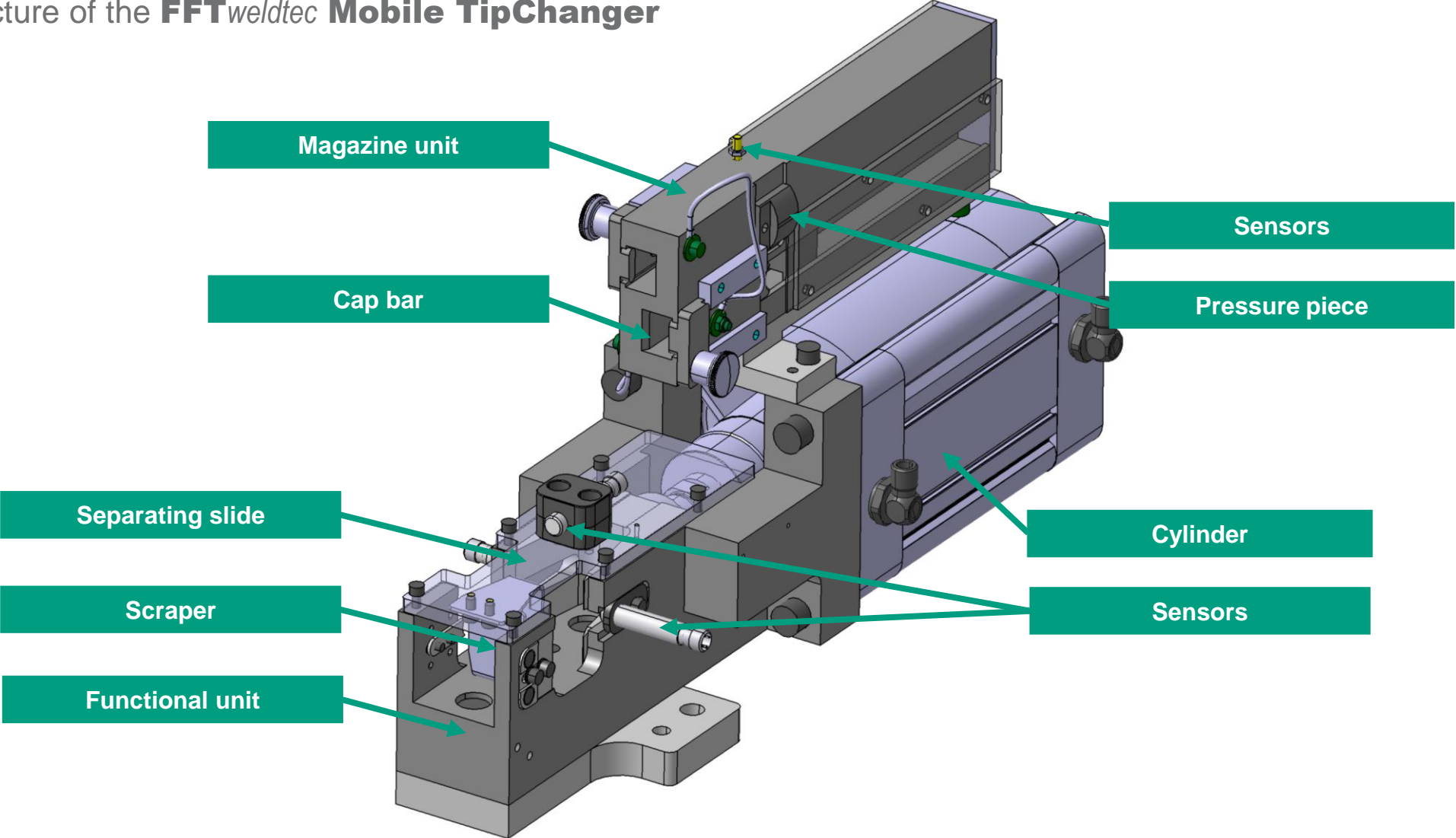

Technische Informationen

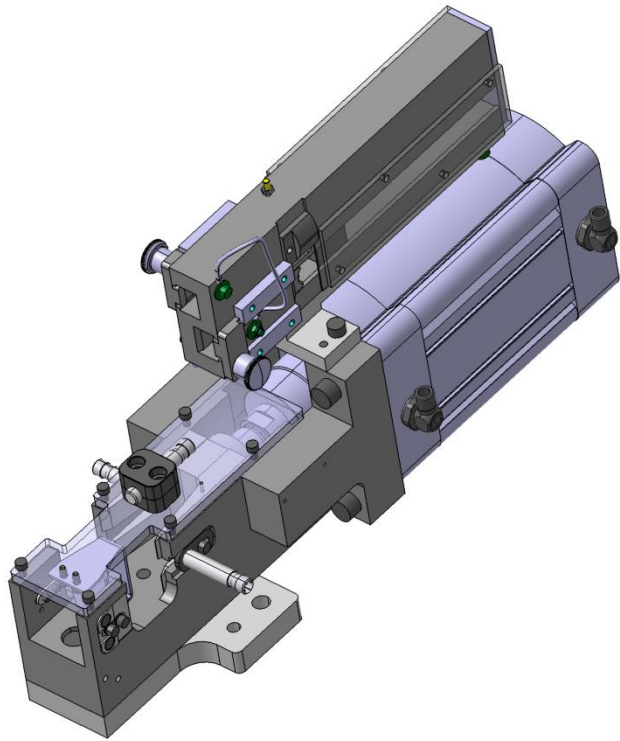

| Technische Daten | |
|-----------------------------------|------------------------------------|
| Height | 300 mm |
| Wide | 200 mm |
| Length | 540 mm |
| Weight | 24 Kg |
| Compressed air | 5,5-6,0 bar |
| Rated voltage | 24 V |
| Filling quantity caps in magazine | 5 Piece per page |
| Time change cycle per clamp | ca. 20 sec |
| Distance cap and shaft | min 3mm, max 6mm |
| Minimum electrode gap | 45 mm |
| Electrode caps | Standard F20x22 more on request |

Robotic Docking

For direct and optimized connection to any industrial robot

- Direct connection of an **FFT*weldtec* Mobile TipChanger** to any robot
- Universally applicable, whether with or without the high force option of the mobile electrode cap changer
- Standardized design guarantees fast delivery times and optimized interfaces
- Individual customer requirements can be taken into account

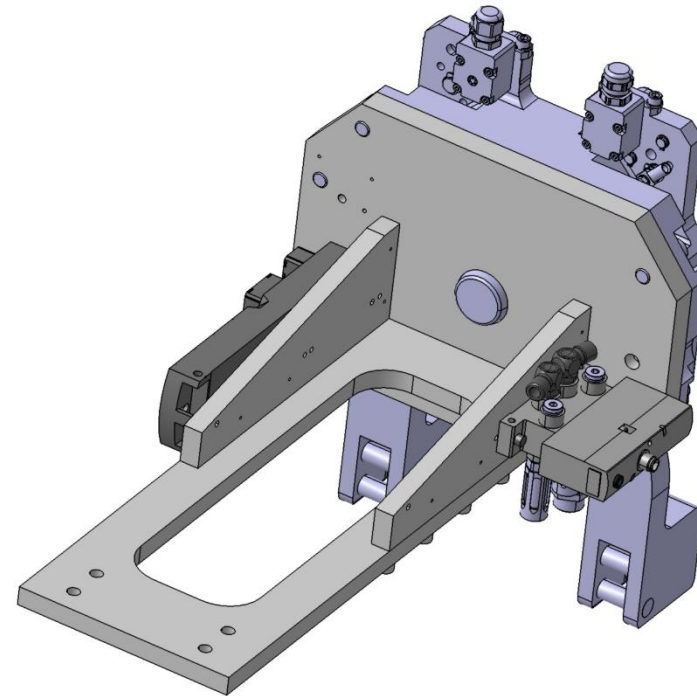

Structure of the docking station

The correct designation of the individual components

FTT weldtec Mobile TipChanger

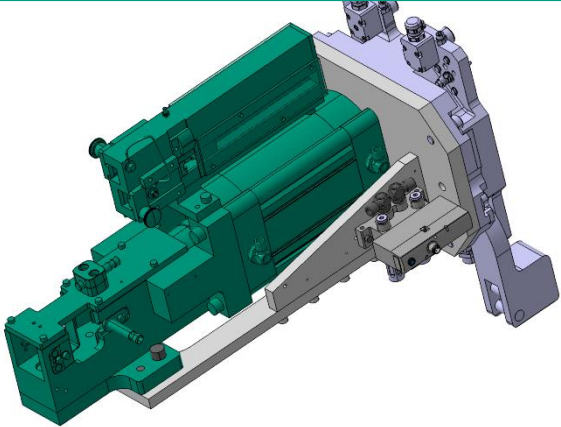

Docking

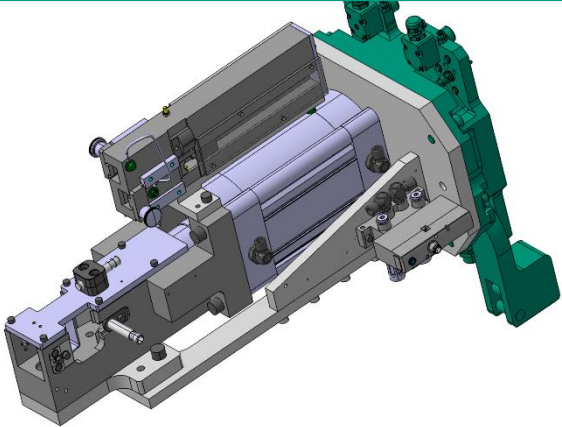

Acquisition unit

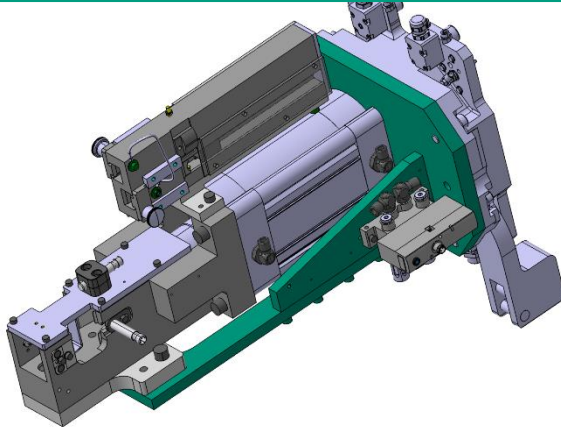

Valve unit

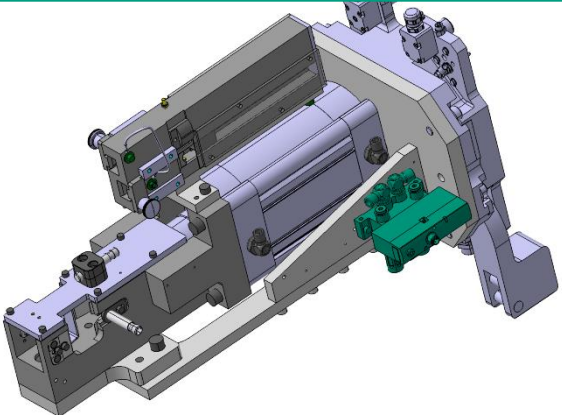

Profinet compact module

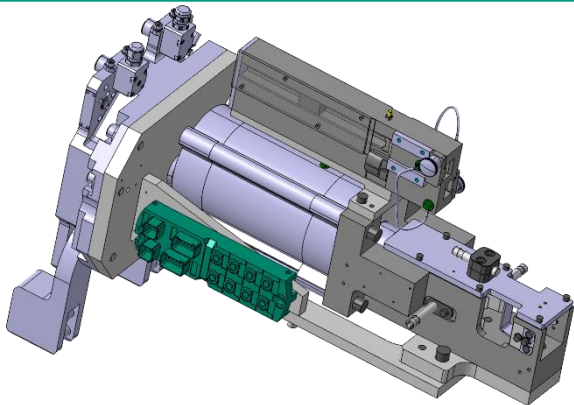



CONTACT

Your personal contact person

Holger Krusch
Department Manager of Welding & Joining Technology

FFT Produktionssysteme GmbH & Co. KG
Schleyerstraße 1, DE-36041 Fulda
Tel.: +49 (0) 661 2926 - 328
Mobil: +49 (0) 171 - 8765319
E-Mail: holger.krusch@fft.de
www.fft.de



THANK YOU

Feel free to contact us.

WWW.FFT.DE | INFO@FFT.DE
TEL.: +49 (0) 661 2926-0

